



**Administrative  
Management Group**

# **2023 AMG LEADERSHIP CONFERENCE**



**April 10, 2023**

**UCLA Meyer & Renee Luskin  
Conference Center**

# For Your Information

## REGISTRATION

The registration table for the conference is located in front of the Centennial Ballroom. It will be staffed throughout the conference for assistance and questions.

## HAVE QUESTIONS OR NEED HELP?

AMG Conference Committee will be wearing lanyard name badges with special identification of "AMG"

## INTERNET ACCESS

Guests can access Wi-Fi through the network "Luskinmeeting," password is LCC2023.

## FOOD AND REFRESHMENTS

As part of your conference registration, we will provide breakfast, lunch, and light refreshments throughout the conference. Complimentary nutrition refreshments hubs will be available throughout the day on the first and second floors near the stairs.

## RESTROOMS: All-Gender, Women's, and Men's restrooms are available.

- Level 1: Women's and Men's restrooms are located between the Lobby and Plateia and around the corner from the Centennial Ballroom. All-Gender restrooms are located across from the Laureate Room.
- Level 2: Women's and Men's restrooms are located across from the Optimist and Legacy Rooms.

## JOIN THE CONVERSATION ON SOCIAL MEDIA!

Follow AMG on Instagram and LinkedIn and use #AMGBruin2023 to share your experience during the conference!



@AMGBruin



@AMGUCLA

## Notice of Audio and Visual Recording

*During this event, we may take photographs, audio record, and video tape. Most likely, you will be filmed, recorded, or photographed as part of the audience, as an individual, or part of a group. In addition, the visual materials may be accessible for viewing online after the event has concluded. With your attendance, you authorize the Regents of the University of California and their appointed agents to photograph, televise, videotape, film, audio record, stream over the internet, duplicate, and/or transfer to any present or future technology your likeness while participating in the 2023 AMG Leadership Conference on April 10, 2023, and agree that the Regents of University of California, their authorized agents, employees, and assignees may use the videotapes, photographs, film, and/or audio recordings prepared therefrom for UCLA archival and marketing purposes. No commercial use of the recordings is intended or will be authorized. No compensation will be paid for this expressed use. If you have any issues with this permission, please notify AMG immediately. Thank you!*

# Letter from AMG

---

## Administrative Sponsor

Dear Colleagues,

Welcome to the 2023 Annual Leadership Conference sponsored by UCLA's Administrative Management Group (AMG)!

Thank you for taking time from your busy schedules to focus on learning and development. As we all know, change in the workplace and in life generally is inevitable. As we experience technological innovations, shifting market realities, and demographic trends, new learning opportunities are created.

This year's AMG Conference, built on the theme of "Developing Tomorrow's Leaders" is designed to offer insights, resources, and tools to help you succeed in a rapidly changing environment at the University. Featured sessions include keynote speakers, panel discussions, and specialized workshops on the challenges we face, as well as practical applications that can help us navigate successfully through change and shape the future workplace.

Please join me in expressing my appreciation to the conference co-chairs Yadra Cano and Ayanna McLeod for planning this wonderful event and to the AMG Board led by current Chair Patty Gonzalez-Johnson for fostering career and professional development at UCLA.



Sincerely,

A handwritten signature in blue ink that reads "Lubbe Levin".

Lubbe Levin

Associate Vice Chancellor

UCLA Campus Human Resources

# Letter From AMG Chair

---

Dear UCLA AMG Conference Participant,

I am honored to be able to welcome you to an in-person conference after being virtual for the last two years! At AMG, we believe in the power of networking and community, and felt it was important to create a space for the UCLA community to come together and learn from each other and connect with one another in-person. Thank you for sharing in this experience with us!

Our theme this year is “Developing Tomorrow’s Leaders” and our conference planning team has worked hard to provide a full day of inspirational speakers and workshops that will include themes such as, resilience, courage, transformation, work-life balance and leadership. We hope these themes spark your curiosity and provide insights that will help you to develop yourself further and the future leaders in your organization!

AMG is committed to helping managers and aspiring managers to continue learning, growing, and developing. Our sponsor, Associate Vice Chancellor, Lubbe Levin is a champion for professional development and believes in nurturing our talent and helping them advance within the University. We hope that you enjoy the conference and share the insights you have learned with your peers and colleagues. We also hope that you will join us in helping develop tomorrow’s leaders!

I would like to thank our AMG Conference Co-Chairs, Ayanna McLeod and Yadira Cano for their dedication to this conference and the tremendous effort they put forth over the past several months to put together an in-person conference! Thank you to Rosa Chung, Julio Gonzalez, Chris Cabrera-Thompson, Grace Fransisca, Carla Gonzalez, Gina Romero, Madelen Hem, Ennily Chan, and the many individuals who contributed to bringing this conference to fruition. I would also like to thank our speakers who have volunteered their time to share their insights and knowledge so that we all may benefit from their wisdom.

Thank YOU, our conference participant, for attending I hope you enjoy the conference!



Sincerely,

A handwritten signature in black ink, appearing to read 'Patty Gonzalez Johnson'.

Patty Gonzalez Johnson, MPA  
Chair, UCLA Administrative Management Group (AMG)

# Conference Overview



**8:00 - 9:00 AM**

## **Registration and Breakfast**

*Centennial Ballroom*

**9:00 - 9:10AM**

## **Welcome and Conference Overview**

*Centennial Ballroom*

Ayanna McLeod & Yadira Cano, AMG Conference Co-Chairs

Patty Gonzalez-Johnson, AMG Chair

**9:10 - 9:25 AM**

## **Campus Leadership Welcome (Video)**

*Centennial Ballroom*

Gene Block, Chancellor

**9:30 - 10:15 AM**

## **Opening Keynote**

*Resilience, Change, and Leadership: Reflections from the Vice Chancellor for Student Affairs*

Monroe Gorden, Vice Chancellor of Student Affairs

**10:30 - 11:45 AM**

## **Morning Breakout Sessions**

See below for locations

### **Managing Work Relationships in a Hybrid World**

*Optimist Room*

SPEAKER: Rejeana Mathis, Lead Manager, Campus Human Resources

### **Resilient Leadership during Transformative Times**

*Legacy Room*

SPEAKER: Dr. Drea Letamendi, Interim Director, Resilience Center (RISE)

Associate Director, Mental Health Training, Intervention and Response for Residential Life

Media Consultant, Behavioral Health Advisor for DNEG, Warner Bros., Marvel, Fandom, Disney+

### **Creating Sustainable Work-Life Balance**

*Laureate Room*

SPEAKER: Lola Engle, Professional & Career Development Coordinator, Campus Human Resources

### **PANEL: Women in Leadership**

*Illumination Room*

SPEAKER: Sheila Davis, Dr. Jessica Montesoglu, Dr. Elizabeth Gonzalez, and Dr. Kristen McKinney

MODERATOR: Rosa Chung

**11:45 AM - 1:00 PM**

## **Lunch and Giveaways**

*Centennial Ballroom*



# Conference Overview

---

1:05- 2:00 PM

## Afternoon Keynote

*Centennial Ballroom*

### Staff Fellowship for "Being a Leader and the Effective Exercise of Leadership"

Khush Cooper, Professor, Academic Program Director

Dylan Stafford, Assistant Dean, Anderson School of Business

Dr. Rachel Bolanos, Executive Director of Behavioral Assessment Research Center, Public Health

2:05- 3:25 PM

## Afternoon Breakout Sessions

See below for locations

### Managing Work Relationships in a Hybrid World

*Optimist Room*

SPEAKER: Rejeana Mathis, Lead Manager, Campus Human Resources

### Resilient Leadership during Transformative Times

*Legacy Room*

SPEAKER: Dr. Drea Letamendi, Interim Director, Resilience Center (RISE)

Associate Director, Mental Health Training, Intervention and Response for Residential Life

Media Consultant, Behavioral Health Advisor for DNEG, Warner Bros., Marvel, Fandom, Disney+

### Creating Sustainable Work-Life Balance

*Laureate Room*

SPEAKER: Lola Engle, Professional & Career Development Coordinator, Campus Human Resources

### PANEL: Women in Leadership

*Illumination Room*

SPEAKER: Sheila Davis, Dr. Jessica Montesoglu, and Dr. Kristen McKinney

MODERATOR: Darlene Mininni

3:40 - 4:25 PM

## Closing Keynote

*Centennial Ballroom*

### The Courage to Lead - Lessons Learned from a Front Row Seat to History

Judy Fortin, Chief of Communications, UCLA Health

4:25 - 4:30 pm

## Closing Remarks

Yadira Cano & Ayanna McLeod, AMG Conference Co-Chairs

# Breakout Sessions



## ***Managing Work Relationships in a Hybrid World, Rejeana Mathis***

Breakout attendees will explore how people managers can maintain a cohesive team and enhance effectiveness while navigating a flexible work model that promotes productivity. Apply principles, build plans, and identify resources for maximize the hybrid experience.

## ***Resilient Leadership during Transformative Times, Dr. Drea Letamendi***

Today's leaders must apply mental flexibility, self-awareness, listening skills, compassion, and creativity. This breakout session will create a supportive space for emerging leaders to reflect on challenges in our professional lives, to connect psychological health strategies to actual successes, and to create paths that go beyond superficial self-care and toward breakthrough performance. Topics include boosting emotional intelligence, learning self-regulating practices, and harnessing mind-body balance.

## ***Creating Sustainable Work-Life Balance, Lola Engle***

The physicist Albert-László Barabási once wrote, "Time is our most valuable non-renewable resource." We are only given an undetermined, finite amount of time on this earth, yet we often lose sight of how precious time is. We fill our schedules with endless meetings, engage in fruitless distractions, and then turn to escapist behavior to calm our internal anxiety. During this workshop, we will explore how time escapes us every day and then learn strategies we can begin to implement in our lives immediately to create more space for intentional usage of our time.

## ***Women In Leadership: Panel, Sheila Davis, Dr. Jessica Montesoglu, Dr. Elizabeth Gonzalez and Dr. Kristen McKinney, Rosa Chung (moderator), Darlene Mininni (moderator)***

This will be a powerful and Interesting session will bring together inspiring women leaders from across campus to share their perspectives and examine the impact that female leaders can have on their organizations and the impact that leadership roles can have on the women who hold them.



# Conference MAP (LEVEL 1)

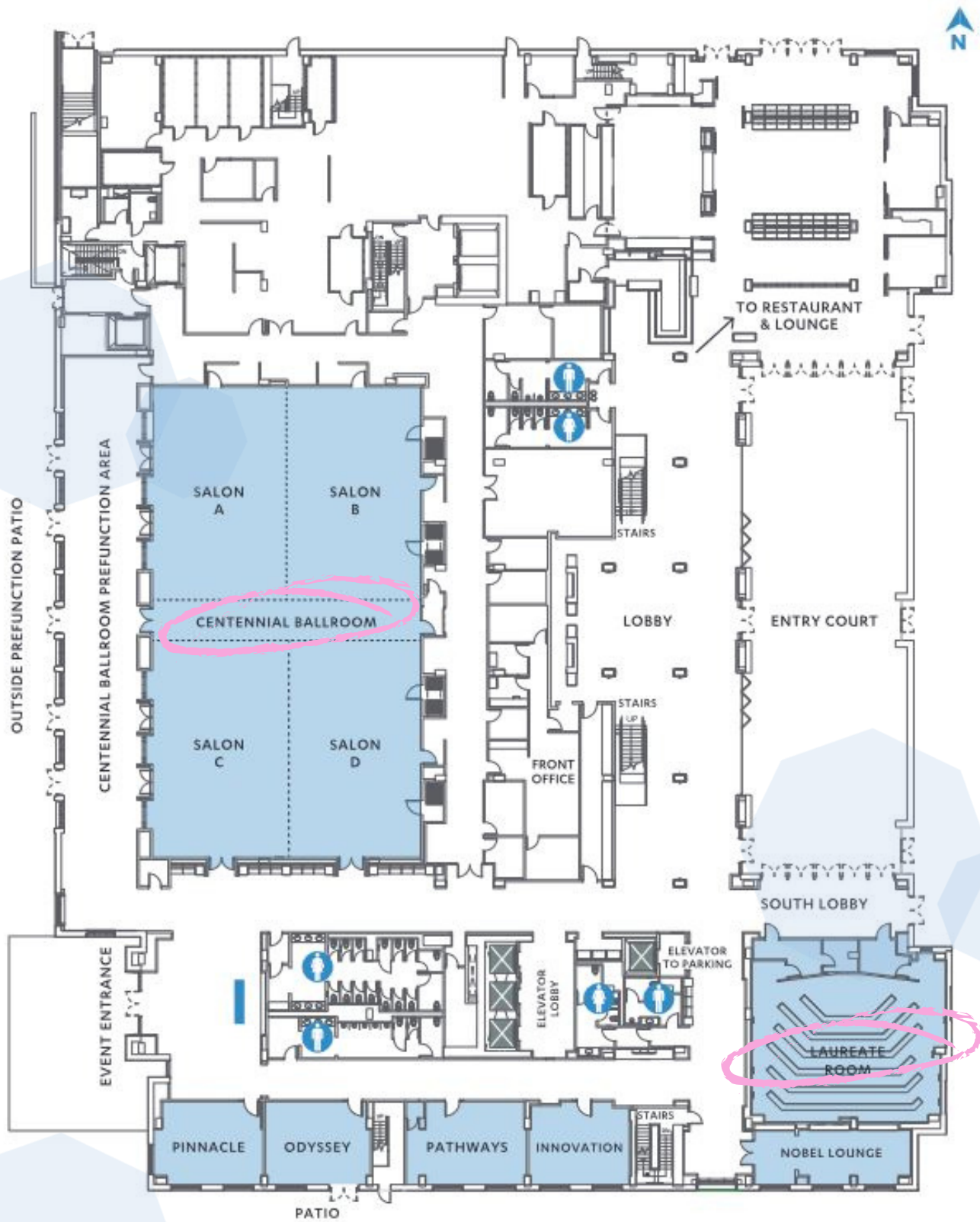



# Conference MAP (LEVEL 2)

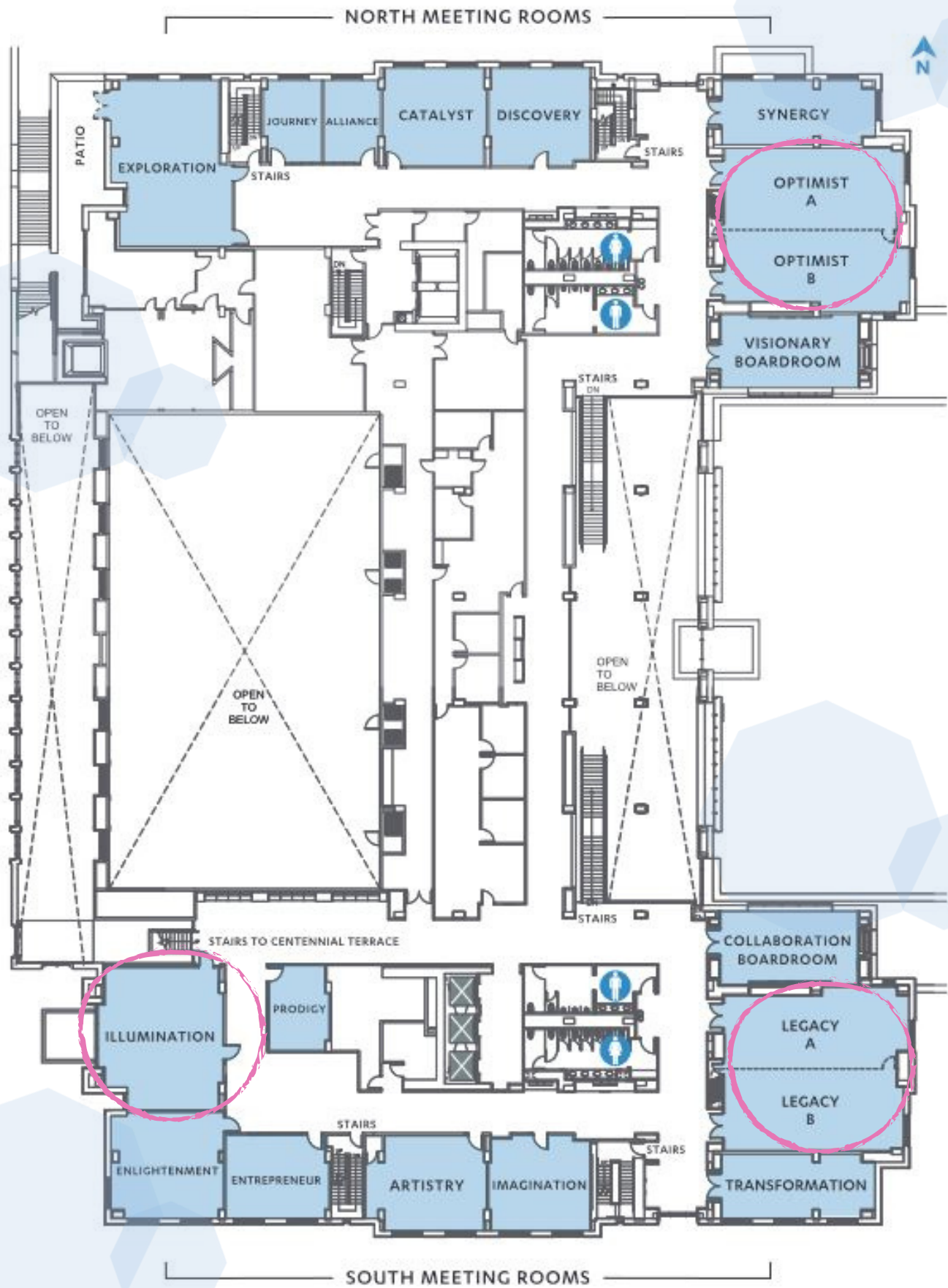

# Conference Speakers

## Rachel Bolanos, MPH, PhD

Rachel Bolanos is a double Bruin graduating with both her Bachelor's and PhD from UCLA as well as an MPH from George Washington University. She currently is the executive director of the UCLA Biobehavioral Assessment Research Center in the Fielding School of Public Health.



She leads the mSTUDY, a U-grant based platform of over 500 substance using men who have sex with men, investigating HIV transmission, opportunistic infections, microbiome and the interaction of social factors on health outcomes in over 37 sub-studies. She has been the administrative leader of the C3PNO consortium of all NIDA funded U-type grants across North America fostering scientific and data coordination, particularly in response to COVID-19. She is contributing to a new initiative of digital based recruitment of virally unsuppressed people living with HIV across the country to better understand the resources needed to maintain care and reduce the spread of HIV in vulnerable communities.

During her first round of graduate work, Rachel had the opportunity to work on HIV transmission, malaria and cholera projects in Eldoret, Kenya as well as a research fellow in the health informatics department at the World Health Organization in Geneva, Switzerland. Other international work has focused on health care infrastructure evaluation and maternal health in Costa Rica and Haiti.

Rachel earned her PhD in Epidemiology focusing on precursor biomarker identification of HIV related malignancies in men who have sex with men, followed by a postdoctoral appointment at USC focused on HPV related malignancies and hematological cancers. Following this, Rachel worked at Amgen, a leading biotech company, focusing on therapeutics for advanced hematological and pediatric hematological cancers.

Outside of work, Rachel lives in Sherman Oaks with her husband, daughter and two very intrusive cats. She enjoys running, reading, creating crafts, and going for walks to local coffee shops.

## Rosa Chung

Rosa serves as the Management Services Officer for the UCLA Center for the Study of Women | Streisand Center. In her current role, she oversees the centers' operations, administration, finances, personnel, and development. She's served in higher education for over a decade and has had the privilege of working for multiple UC campuses including UC San Diego and UC Santa Cruz. In her spare time, she enjoys hanging out with Pogo, her rescue pup, and playing beach volleyball.



## Khush Cooper, MSW, PhD

Dr. Cooper teaches 'Being a Leader: An Ontological Phenomenological Approach' and 'Public Policy for Children and Youth' at the Luskin School of Public Affairs at UCLA. She received her MSW and PhD in Social Work from Luskin. As a social entrepreneur and specialist in the study and implementation of what's next for human services, Dr. Cooper uses long-standing relationships with policy-makers, leading practitioners, and consumers to shield and guide California's organizations, both public and private, through reform initiatives. Starting out as a group home child care worker, she has held the positions of house manager, foster care social worker, non-public school teacher, FFA Director, and Director of Research and Quality at the Gay and Lesbian Adolescent Social Services.

Her firm, Khush Cooper and Associates, is currently conducting the first ever LGBTQ Youth Preparedness Scan for LA County which assesses all 11 county departments' capacity to properly serve LGBTQ children, youth and families in order to prevent future disproportionality of these youth in the child welfare system. KC&A also currently developing an e-learning platform, Implematix, to support foster care providers with AB 403 implementation. Other projects have included inventing a practical and staff-friendly system for performance management for foster care providers in California, initiating two of the multi-million dollar federal Permanency Innovations Initiative grants in the country (the RISE Project, CAPP), and managing the implementation of three of the five state-wide Residentially Based Services (RBS) demonstration projects in California. She is a founding board member of the LA LGBT Child Abuse Prevention Council and consults on a local, state and national level in the area of LGBT youth in systems.



# Conference Speakers

---



## Sheila Davis

Sheila Davis is the Assistant Dean of Administration and Human Resources Director for the UCLA School of Nursing. Sheila has over 39 years of UC experience; 33 of which have been at UCLA. She has served various departments and units including; Campus Payroll, External Affairs, African Studies, Asian American Studies, Semel (formerly NPI), SEIS (formerly GSEIS), Department of Neurology in School of Medicine and now School of Nursing. Her extensive UC knowledge base covers Student Affairs, Admissions, Payroll, Human Resources, Accounts Payable, Research Administration, Compliance, Facilities Management, and Administration.

As Assistant Dean of Administration and Human Resources Director, Sheila is responsible for managing the day to day operations of the School of Nursing, including its facilities. She oversees and manages all HR related matters for faculty and staff. She represents the Dean's Office to campus constituencies and serves as the liaison to external agencies regarding administrative matters.



## Lola Engle

Lola Engle is a workshop facilitator and career management coach with over ten years of experience working for UCLA. She began her career in the Summer Sessions Department, eventually managing the student affairs team as one of the unit's associate directors. Currently, she works for Campus Human Resources (CHR), managing a 10-month-long career development program called the Staff Enrichment Program (SEP). Engle's educational background includes a bachelor's degree in Psychology from UCLA, and she is currently completing her master's degree in Organizational Leadership and Learning from Pepperdine University.



## Judy Fortin

Judy Fortin is Chief of Communications for UCLA Health and the David Geffen School of Medicine in Los Angeles, California. She leads a team that is responsible for all media relations, reputation management, internal communications, content creation, and government relations at one of the top health systems in the United States.

Prior to joining UCLA in 2019, Judy served for six years as Senior Director of Communications at Winship Cancer Institute of Emory University. Previously, she was National Director of Media Relations for the American Cancer Society. She spent 19 years as an anchor and correspondent at CNN and CNN Headline News in Atlanta. She won multiple national awards for her work as a CNN Medical Correspondent. Previously, she was a reporter for WCVB-TV in Boston and WMUR-TV in Manchester, New Hampshire.



# Conference Speakers

## Dr. Elizabeth Gonzalez

Dr. Elizabeth Gonzalez takes on the role as inaugural Hispanic-Serving Institution (HSI) Director in the UCLA's Office of the Chancellor. She is a Nuu Savi (Mixtec) migrant and first-generation college graduate who bridges research and practice to advance equity and social justice in higher education. She graduated with a B.A. in psychology and education studies from UCLA, an M.S. and Ph.D. in psychology from UC Santa Cruz.



Dr. Gonzalez has strengthened institutional capacity to close equity gaps in transfer pathways and student success outcomes through her various roles in Academic and Student Affairs, and Institutional Research at the University of California and California Community College systems. She has led efforts to design, implement, and institutionalize multiple HSI grants at UC Santa Cruz, San José City College, and San Diego City College, totaling nearly \$14 million. Through ESCALA, she has collaborated and coached institutional teams working collectively on campus-wide efforts to close institutional equity gaps in serving Latinx, low-income and first generation students.

Gonzalez is a published mixed-method scholar on the topic of Indigenous Latinx identity. She serves as Vice President of Conference for the Alliance of HSI Educators (AHSIE). AHSIE exists to support the work of the nation's HSIs, and Dr. Gonzalez has a robust network of leaders, practitioners and educators engaged in similar efforts across HSI campuses.

She will ensure UCLA makes progress towards our shared goal of becoming the HSI of choice for Latinx and low-income students through collective action, courageous innovation, and inclusive excellence.

## Monroe Gorden, Jr.

Vice Chancellor Monroe Gorden, Jr. provides leadership for an integrated network of more than 20 departments whose programs, services, and experiences connect at some point with every UCLA student in virtually every aspect of life outside the classroom. Student Affairs spans the entire range of student needs and interests from early outreach through graduation, housing, physical and emotional wellness, recreation and student organizations, and a host of other services and opportunities in between.

Monroe began his work at UCLA in 2006 as the Chief Administrative and Financial Officer. He has taken on several roles during his 15 years at UCLA, including working as the Assistant and Associate Vice Chancellor in Student Affairs in which he managed 11 Student Affairs units and retained responsibility for budget, human resources, and compliance for the organization. Finally, he also worked as the ADA/504 Compliance Officer for UCLA, providing guidance to improve access to campus facilities and programs for individuals with disabilities.

Monroe received his Bachelor of Arts (Political Science) degree, with a Business Emphasis, from UCLA and his Juris Doctorate degree from Pepperdine University School of Law. He is a member of the California State Bar and is licensed to practice law within the State of California.



## Dr. Drea Letamendi

Dr. Drea Letamendi (she/her/ella) is a clinical psychologist, media consultant, and TEDx speaker with degrees from Cornell University, UCSD, and UCLA. For 3 years, Dr. Drea served as the Interim Director of the Resilience Center at UCLA known as "RISE." As the Associate Director of Mental Health Training, Intervention, and Response in Residential Life, she continues to lead projects in the areas of resilience, crisis-response, and suicide prevention. Dr. Drea has a private practice as a behavioral health advisor for the gaming, visual effects, and entertainment media industries (Riot Games, Warner Bros., Marvel, and Disney). She has written publications about the positive impacts of media storytelling on mental health, as covered in the Atlantic, the Guardian, and the Los Angeles Times. Her latest publication with Springer is titled, *The Force Awakens: Mindfulness-Based Cognitive Behavioral Therapy Using Star Wars*.



# Conference Speakers

---



## Rejeana Mathis

Rejeana Mathis is the Lead Manager of Learning & Organizational Development at UCLA Campus Human Resources. She has more than 25 years of experience in leadership, program and project management, and organizational and individual needs assessment, evaluation and measurement. As an active campus leader, Rejeana served as UCLA Staff Assembly president from 2014–15. In 2015, she served as chair-elect and then chair of CUCSA. During her term as chair, CUCSA focused on the staff experience through the lenses of diversity, work-life balance, advocacy, and financial and retirement literacy. For her distinguished service, she received the Kevin McCauley Memorial Outstanding Staff Award in 2019.



## Dr. Kristen McKinney

Dr. Kristen McKinney has served as the Chief of Staff and Chief Financial Officer for UCLA's Division of Graduate Education since November 2021. Prior to that role, Dr. McKinney spent more than 10 years as the Director for the Student Affairs Information and Research Office (SAIRO). Prior to joining SAIRO, Dr. McKinney held a variety of student affairs and institutional research and assessment positions across UCLA.

Dr. McKinney's professional service leadership includes two terms on the Directorate Board for ACPA's Commission for Assessment and Evaluation, including a term as Commission Chair, as well as serving for many years as the UC representative to the Student Experience in the Research University (SERU) consortium. Dr. McKinney served as a faculty member for the ACPA Assessment Institute for eight years, and Institute Chair for two. Dr. McKinney's teaching experience includes serving as lecturer at UCLA teaching a variety of courses in education topics, particularly student development and campus climate. Currently she serves as a Lecturer for University of Wisconsin, La Crosse in the Student Affairs Administration Ed.D. program.



## Dr. Jessica Montesoglu

As Head of IT Operations and Services (Digital Initiatives and Information Technology) for the UCLA Library, Jessica Montesoglu leads teams of technology support and services experts and designs and implements systems and services tailored to the needs of UCLA Library staff, and UCLA faculty, staff and students through the Library and CLICC services. These teams include the service desk, learning and research technology, project management, workflow design, reporting and logistics. Her professional experience has been in the field of instructional technology, specifically web development, content and project management. She has developed web sites and assisted in computer-aided instruction for countless courses and organizations in all fields, especially foreign languages. She studied international relations at Georgetown University, received a Ph.D. in Near Eastern Studies with a concentration in the areas of Turkish and Late-Ottoman studies from Princeton University, and taught Turkish at Santa Monica College. She is proud to be an EDUCAUSE Leading Change Institute (formerly the Frye Institute) Fellow class of 2017.

# Conference Speakers



## Darlene Mininni

Darlene Mininni is a consultant with UCLA Learning & Organizational Development where she teaches, advises and conducts research to promote success and wellbeing among UCLA leaders and staff. She also oversees UCLA's participation in the UC Women's Initiative for Professional Development as part of the Systemwide Committee on the Status of Women. Previously, Darlene was Chief Learning Officer at UCLA Extension and started her UCLA career as Director of the Applied Psychology Program at the Arthur Ashe Health & Wellness Center where she created the popular undergraduate course LifeSkills. Darlene holds a PhD in clinical psychology and an MPH in behavioral health.

## Dylan Stafford

Since 2002, Dylan Stafford has been a leader at UCLA Anderson's Fully Employed MBA Program, expanding from 560 to over 900 students and becoming the #2 graduate program student body in all of UCLA. Dylan created SuperSaturdays (over 8,000 admission interviews to-date conducted by over 2,000 volunteers), FEMBAssadors, FEMBApalooza, and the UCLA Drive Time podcast, among other initiatives. He teaches Stand & Deliver, and is training to teach Being a Leader and the Effective Exercise of Leadership: An Ontological/Phenomenological Model.

Since 1996, in both Bloomberg BusinessWeek and US News & World Report, FEMBA has ranked between #1 and #6 in the nation. FEMBA consistently earns top marks for Student Satisfaction, Caliber of Classmates and Teaching Quality.

Before UCLA, Dylan was a Change Management and Human Resources Consultant for Siemens AG, one of the world's largest companies. From the Silicon Valley he was promoted to a three-year assignment at the global headquarters in Munich, Germany, where he founded InterGreat!, a social-networking platform for high-potential European managers.

Dylan earned his MBA from the Chicago Booth School of Business, with concentrations in Finance and Marketing. He graduated with honors from Texas A&M University, was a member of the Corps of Cadets and served on the Ross Volunteers, the Honor Guard of the Governor of Texas. He speaks German and Spanish. In 2018, Dylan released his second book, Building a Winning Organization. In 2010, he published his first book Daddy Muscles.

Originally from Texas, Dylan now enjoys life in Los Angeles with his wife Marisa, their two sons, and two Maltipoos. They are members of St. Monica's Catholic Community, in Santa Monica..



# Conference Planning Committee



Yadira Cano  
AMG Conference Co-Chair  
Senior Manager of Administration  
Registrar's Office



Ayanna McLeod  
AMG Conference Co-Chair  
Office Manager  
UCLA Health Real Estate  
Planning, Design & Construction



Chris Cabrera-Thompson  
AMG Conference - IT Coordinator  
AMG IT Coordinator  
IT Manager  
English



Rosa Chung  
AMG Conference - Finance & Swag  
AMG Member-at-Large  
Management Services Officer  
Center for Women's Studies | Streisand Center



Grace Fransisca  
AMG Conference - Program & Logo  
AMG Events Coordinator  
Fund Manager  
Neurobiology



Carla Gonzalez  
AMG Conference Committee  
AMG Member-at-Large  
OAST & Project Manager  
Anesthesiology & Perioperative Medicine



# Conference Planning Committee



Julio Gonzalez

AMG Conference - Program & Logo  
AMG Communications Liason  
Budget and Personnel Coordinator  
Dashew Center for International Students  
and Scholars



Madelen Hem

AMG Conference - Registration  
Student Affairs Officer  
Computer Science



Patty Gonzalez-Johnson

AMG Conference Committee  
AMG Chair  
Senior Manager of Academic Services & Operations,  
Anderson School of Management, Full-Time MBA



Mathew Marquez

AMG Conference - Social Media  
AMG Member-at-Large  
Data & Analytics Reporting Developer  
LMS Center of Excellence



Gina Romero

AMG Conference - Sponsorship & Donations  
AMG Vice Chair  
Manager of Training & Organizational Development  
Events & Transportation



Parama Sigurdson

AMG Conference Committee  
AMG Member-at-Large  
Assistant Director of Programming  
Institute for Pure & Applied Mathematics (IPAM)

***We would like to thank all of our volunteers for serving on the committee for AMG 2023 Annual Leadership Conference. Your support of AMG's mission allows us to serve the Bruin Community each year, providing access to professional development and leadership opportunities.***

# Acknowledgments

---

## THANK YOU TO OUR CONFERENCE SPONSORS!

We are grateful to our generous sponsors, whose support allows us to offer this valuable opportunity to staff across campus and who have demonstrated their commitment to professional development and the growth of leadership at UCLA.



## Show Appreciation and Boost Morale!

UCLA AMG has partnered with the UCLA Store to offer custom gift bags for all occasions! Mix-and-match items to create the perfect gift for

Visiting faculty and guest speakers

Department retreats

New recruit welcome gifts

Retirement, graduation, and holiday gifts

Departments paying with LVO receive an exclusive 10% discount. Select fast, free delivery to your office, or pick up from the UCLA Bookstore.

Please contact Tony Vallejo to place your order:

310-206-1442

avallejo@asucla.ucla.edu



Additional items available. View full gift selection at:  
[https://shop.uclastore.com/t-department\\_gifts.aspx](https://shop.uclastore.com/t-department_gifts.aspx)

Department funds are to be used for appropriate University business only. This is a UCLA AMG fundraiser. A portion of the proceeds will go towards supporting professional development workshops, career and skill-building sessions, networking opportunities, and the annual AMG Excellence Awards ceremony.

# Join AMG



## UNLOCK YOUR POTENTIAL

Our professional development workshops transform today's professionals into the leaders of tomorrow

## WE ARE YOU

The Administrative Management Group (AMG) is dedicated to the professional development of UCLA's current and aspiring managers. Sponsored by Campus Human Resources, we are the UCLA chapter of the University of California Administrative Management Professionals (AMP).

## MEMBERSHIP

AMG Membership includes staff at all levels. Committed to the pursuit of excellence, AMG reaches a community of over 800 professionals across the UCLA campus and medical centers.

## AMG PROVIDES

- Career development events, training workshops, and networking activities
- Opportunities to collaborate through committee service
- Mentorship and special support programs

## JOIN ONE OF UCLA'S FOREMOST ADVISORY GROUPS AND LEARN MORE ABOUT WHAT AMG CAN DO FOR YOU

Visit [amg.ucla.edu](https://amg.ucla.edu) and subscribe to our listserv.

